

# DIN 850 B

Frezy do rowków Woodruffa ostrza na przemian skośne

Woodruff keysat cutters staggered teeth

Schlitzfräser für Scheibenfedernuten, kreuzverzahnt

Фрезы для шпонок типа Woodruff с разносторонними зубьями

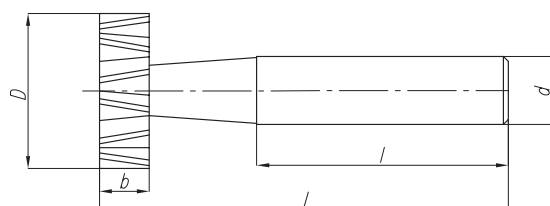

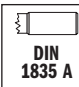
<b>DIN 850 B</b>	<b>Z=6+12</b>	$\lambda=8^\circ$ $\gamma=10^\circ$	 <b>DIN 1835 A</b>
----------------------	---------------	--	---

Form B – chwyt walcowy / plain shank / Zylinderschaft / плоский хвостовик

D (h12)	d (h8)	L	l	b	z	HSS	
						Code No 0641-599-	
10.5	6	50	36	2	6	230106	●
10.5	6	50	36	2.5	6	230208	●
10.5	6	50	36	3	6	230300	●
13.5	10	56	40	2	6	230401	●
13.5	10	56	40	2.5	6	230503	●
13.5	10	56	40	3	6	230605	●
13.5	10	56	40	4	6	230707	●
16.5	10	56	40	3	8	230900	●
16.5	10	56	40	4	8	231005	●
16.5	10	56	40	5	8	231107	●
19.5	10	63	40	3	8	231209	●
19.5	10	63	40	4	8	231300	●
19.5	10	63	40	5	8	231402	●
19.5	10	63	40	6	8	231456	●
22.5	10	63	40	4	10	231504	●
22.5	10	63	40	5	10	231606	●
22.5	10	63	40	6	10	231708	●
22.5	10	63	40	8	10	231751	●
25.5	10	63	40	5	10	231800	●
25.5	10	63	40	6	10	231901	●
25.5	10	63	40	8	10	232006	●
28.5	10	63	40	5	10	232108	●
28.5	10	63	40	6	10	232151	●
28.5	10	63	40	8	10	232164	●
28.5	12	71	45	10	10	232177	●
32.5	12	71	45	6	10	232301	●
32.5	12	71	45	7	10	232403	○
32.5	12	71	45	8	10	232505	●
32.5	12	71	45	10	10	232559	●
38.5	12	71	45	8	12	232607	●
45.5	12	71	45	8	12	233356	●
45.5	12	71	45	10	12	233404	●